







Contents				
About This Manual	FAQ	EcoFlow App	After-sales Policy	Community
Overview				
Appearance				
Control Panel				
Display				
Before Use				
Handling				
Ideal Location				
Get Started				
Connect Power				
Open the Lid				
Power On/Off				
Set Temperature				
Switch Mode				
Child Lock				
Management				
Download EcoFlow App				
Bind Device and Set Up Internet				
Control via Phone				
Food Storage Precautions				
Maintenance and Care				
Safety Instructions and Regulatory Compliance				
Disclaimer				
Safety Instructions				
Regulatory Compliance				
Compliance Warning				

About This Manual

- This user manual applies to the 35L, 45L, and 55L models of the GLACIER Classic.
- The terms "GLACIER Classic" in this manual shall refer to EcoFlow GLACIER series products.
- Please note that this manual may be updated without prior notice. If you are reading this manual in PDF format, please note that you can access it online at [EcoFlow Support](#) for a better experience and the latest updates.
- The illustrations in this manual are for demonstration only. Please refer to the actual product received.
- The availability of certain accessories and features described in this manual may vary depending on your country or region.

Overview

Appearance



1	Divider Latch (45L/55L Only)	Secures the divider on the bottom of the lid.
2	Light Strip*	Provides illumination inside the refrigerator.
3	Divider Location Ribs (45L/55L Only)	Guides and holds the divider within the refrigerator.
4	Battery Compartment Cover	Covers an interface to install a plug-in battery.
5	Lid Latch	Used to open or remove the lid.
6	Display & Control Panel	Displays operating status. Provides hardware control buttons for various functions.
7	Handle	Used to lift and carry the refrigerator.
8	Air Outlet	Dissipates the internal heat.

*The number of light strips varies by model.



9	Air Inlet	Dissipates the internal heat.
10	Input Port (XT60)	Connects the refrigerator to a power source.

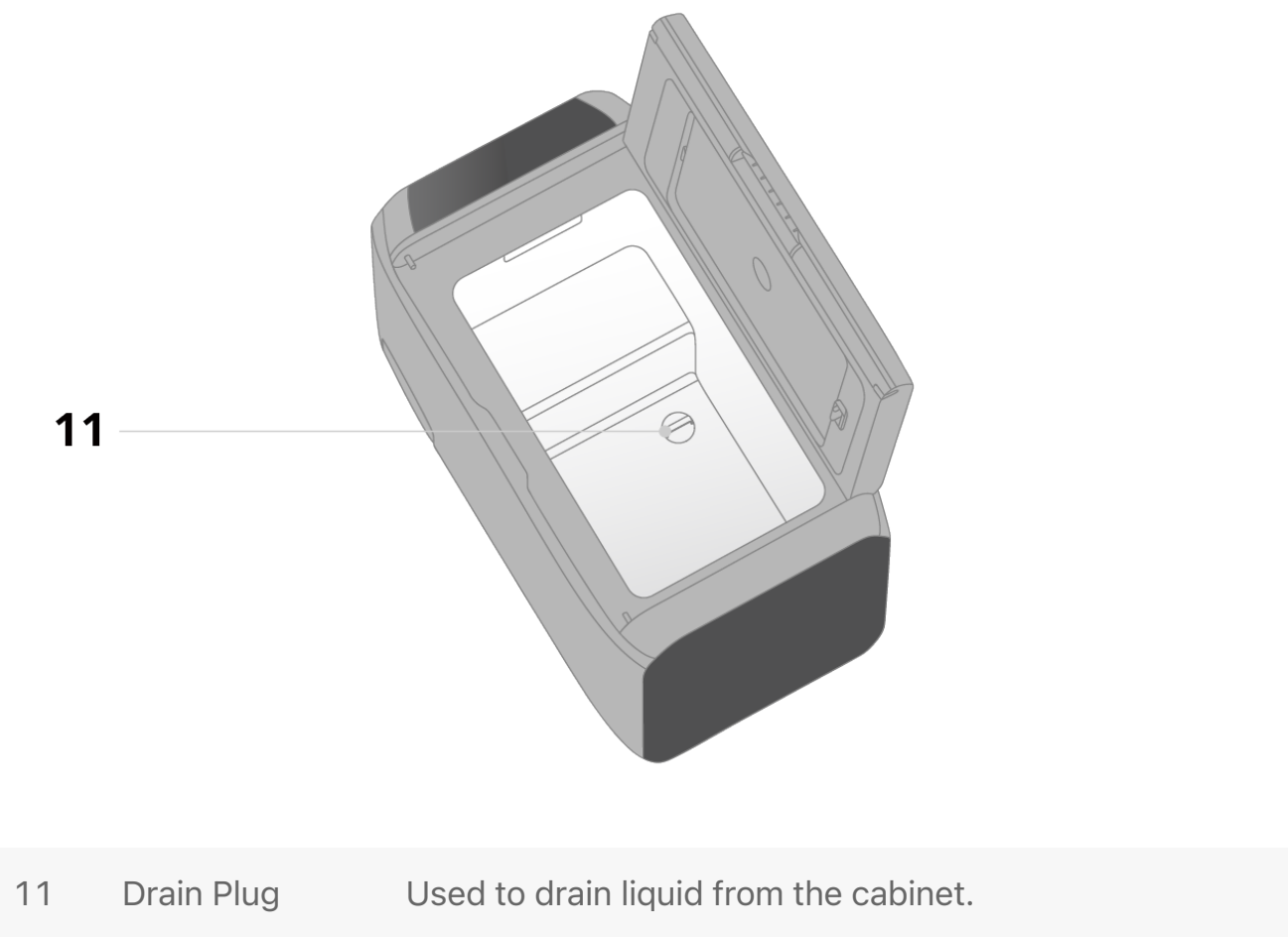

11 Drain Plug Used to drain liquid from the cabinet.

Control Panel

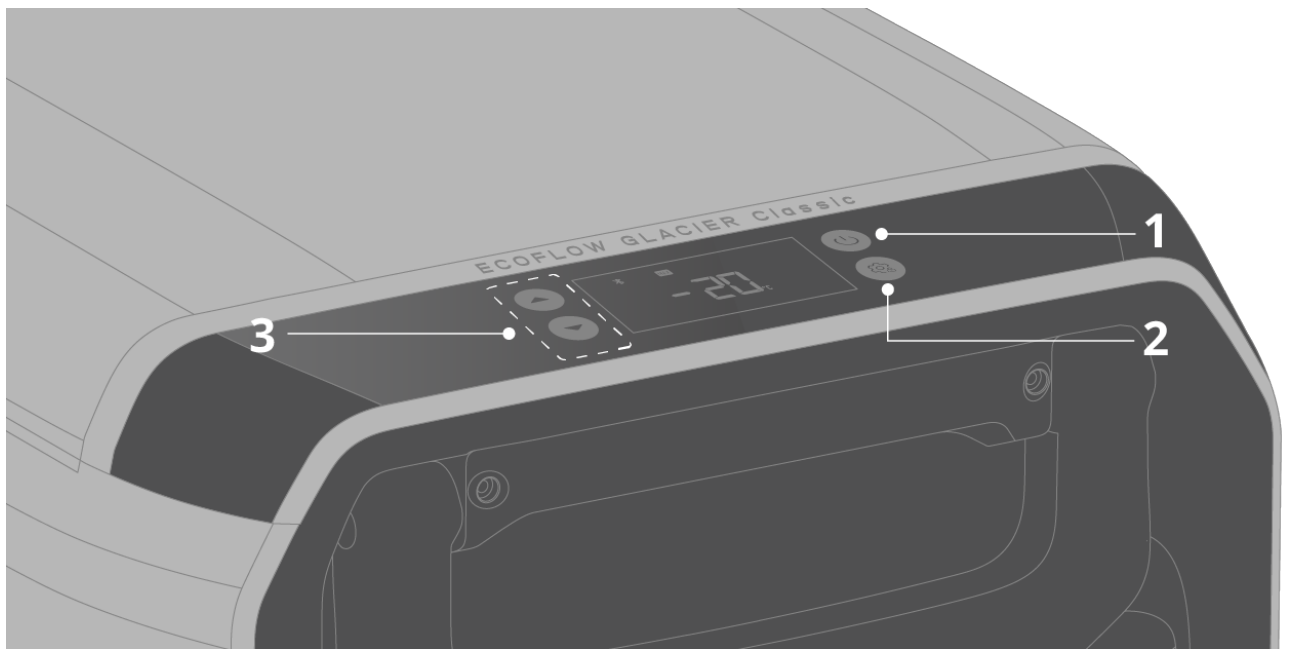

1 Power Button The button serves the following functions:
Power On/Off: Press and hold for 2 seconds.
Screen Off: Press once when the refrigerator is on.
Confirm Temperature Setting: Press once to confirm the temperature setting without waiting.

2 Setting Button The button serves the following functions:
Switch Mode: Press once.
Switch Setting Zone (45L/55L Only): Press once when setting temperature.
Enable/Disable Child Lock: Press and hold for 2 seconds.

3 Adjustment Button (Up) & Adjustment Button (Down) The buttons serve the following functions:
Setting Temperature: Press once to enter temperature settings. Then, press once to increase or decrease by 1°C/°F, or press and hold to adjust quickly.
Switch Temperature Unit: Press the Up and Down buttons simultaneously for 2 seconds.



Tip

After the display turns off, you can wake it up by pressing any button briefly.

Display

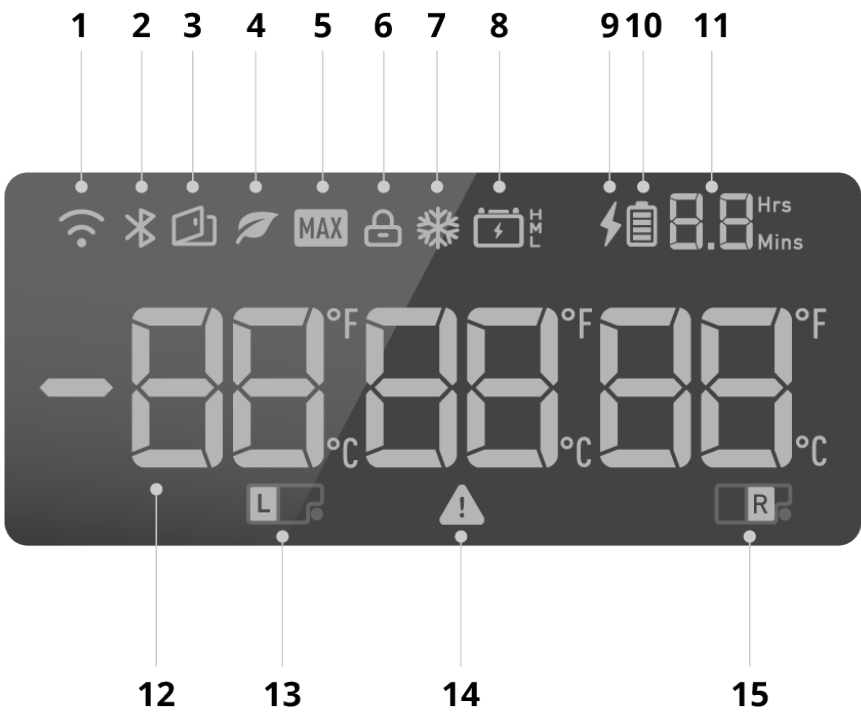

1	Wi-Fi	On: The refrigerator is connected to the internet via a wireless network.
2	Bluetooth	On: The refrigerator is connected to a Bluetooth device.
3	Lid Alarm	Flashing: The lid has been left open for over 5 minutes. Close the lid to ensure optimal cooling performance.
4	Eco Mode	On: The refrigerator is in Eco Mode. In this mode, the refrigerator uses less power, extending running time.
5	Max Mode	On: The refrigerator is in Max Mode. In this mode, the temperature control is quicker and more accurate, though power consumption is higher.
6	Child Lock	On: Child Lock is enabled. The control panel is disabled to prevent accidental operation.
7	Cooling Status	On: The display is off, but the refrigerator is still working.
8	Car Battery Protection	Battery: Car Battery Protection is enabled. H/M/L: Corresponds to three settings (High/Medium/Low)
9	Plug-in Battery Charging Status	On: A plug-in battery is connected and charging. The number of battery bars represents the battery's charge level.
10	Plug-in Battery Connection	On: A plug-in battery is connected. The number of battery bars represents the battery's charge level.
11	Remaining Charging / Discharging time	On: Displays the remaining charging or discharging time of the connected plug-in battery.

On: Displays a temperature zone's real-time temperature.

12	Temperature	Flashing: Displays the temperature being set for the zone you are adjusting.
13	Left Zone (45L/55L only)	On: Dual zones are activated, and the left zone is in operation.
14	Error Code	Flashing: An error has occurred. Check the EcoFlow in-app instructions for troubleshooting.
15	Right Zone (45L/55L only)	On: Dual zones are activated, and the right zone is in operation.

Before Use

Handling

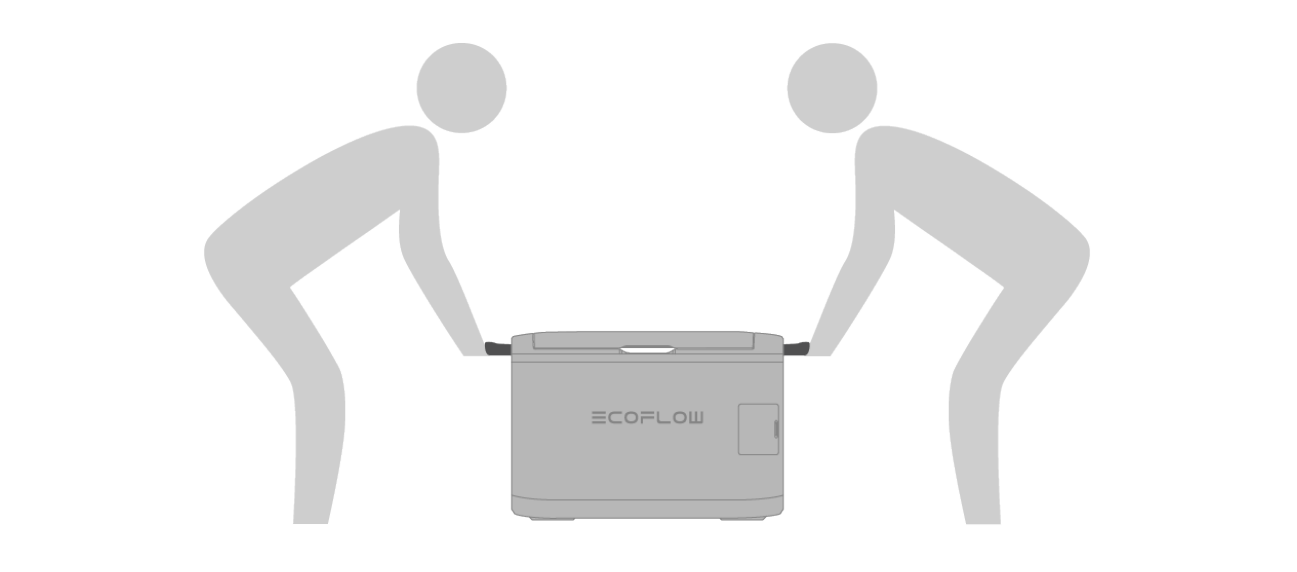

The refrigerator is equipped with two handles for transportation.

At least two people are required for transportation.

Do not use the lid latch to move the refrigerator.

Ideal Location

To reduce energy consumption and ensure the refrigerator operates properly, its placement should meet the following conditions:

- The location should be clean, dry, and not exposed to rain.
- There should be adequate ventilation, with at least a 50mm gap on all four sides of the refrigerator.
- The surface should be stable and level, with an incline of less than 30° to avoid triggering the tip-over protection due to prolonged tilting.
- The placement should meet the temperature requirements, avoid direct sunlight, and keep the refrigerator away from heat sources and flames.
- Avoid placing the refrigerator in areas with high gas or smoke levels, as this may cause discoloration of the surface.
- Placing the refrigerator on a carpet is not recommended, as the carpet may absorb drainage water and lead to mold growth.



Tip

If the anti-tip protection is triggered, please return the refrigerator to an upright position. The protection will be cleared after 1 minute.

Get Started

Connect Power

From a Wall Outlet

Connect the refrigerator's input port to a wall power outlet using the included AC Power Adapter.

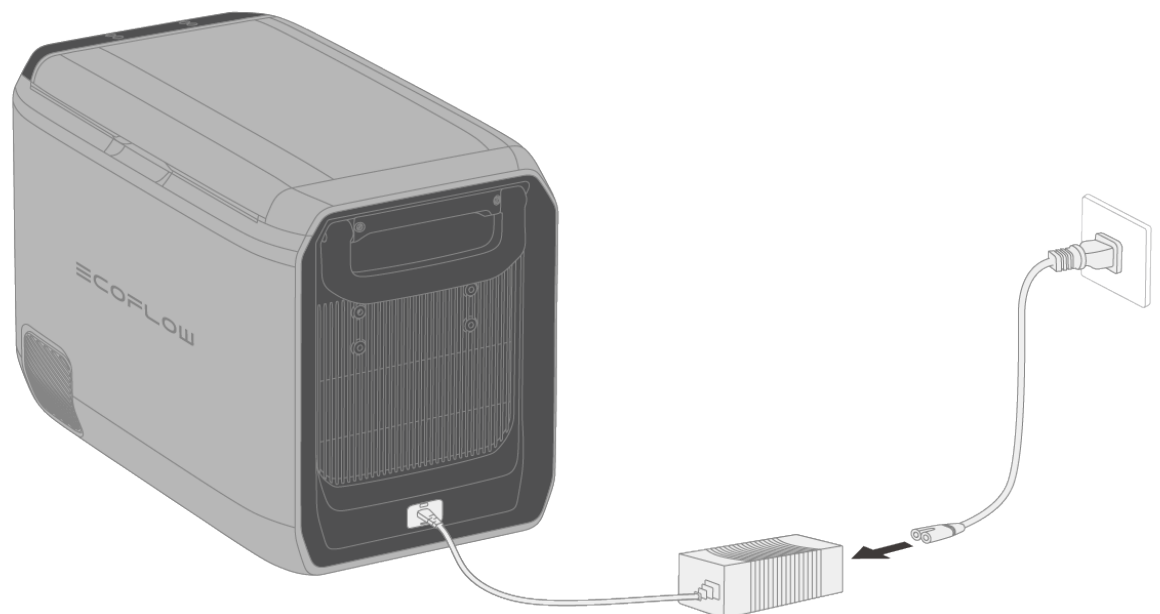

Use a dedicated power outlet, and do not share the outlet with other appliances.

From Plug-in Battery

The refrigerator supports power supply from the EcoFlow GLACIER Plug-in Battery (hereinafter referred to as the "plug-in battery").

Install the Plug-in Battery



Notice

Before installing the plug-in battery, carefully read [the plug-in battery's user manual](#).

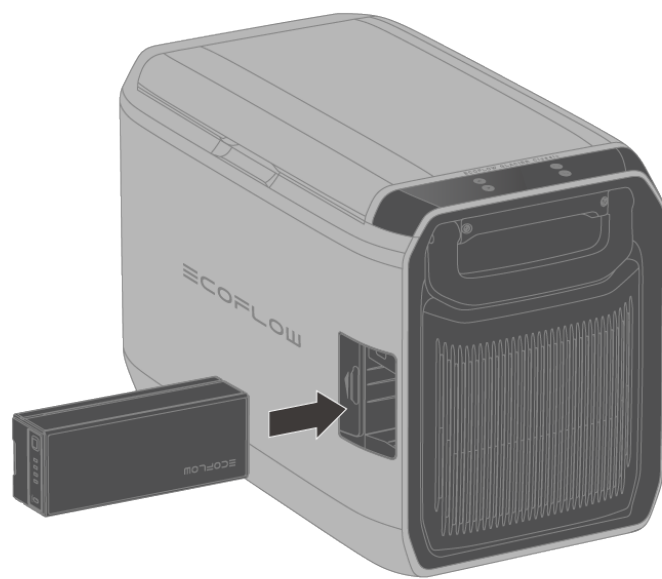

1. Open the refrigerator's battery compartment cover.
2. With the side of the plug-in battery containing the interface and the button facing outward (the button should be in the top right corner), insert the plug-in battery into the compartment.
3. When the battery icon appears on the refrigerator's display, it indicates that the plug-in battery has been successfully connected.



Tip

After the plug-in battery is connected, if power is supplied to the refrigerator's input port, this power will be used primarily for cooling. Any excess power will charge the plug-in battery.

Remove the Plug-in Battery

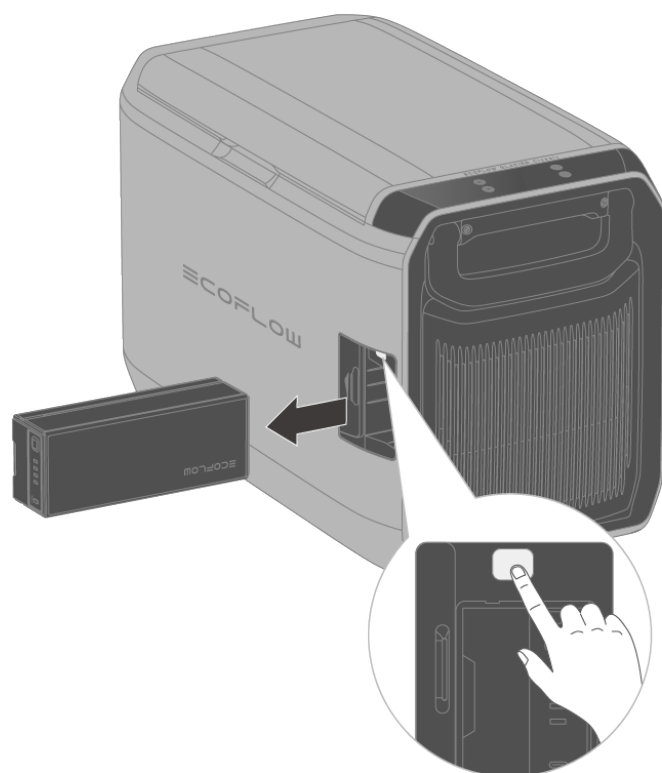

1. Open the refrigerator's battery compartment cover.
2. Press the battery removal button.
3. Remove the plug-in battery.
4. Close the battery compartment cover.

From Solar

With the plug-in battery connected, use an EcoFlow Solar to XT60i Charging Cable to connect the solar panel to the refrigerator's input port to use solar power.

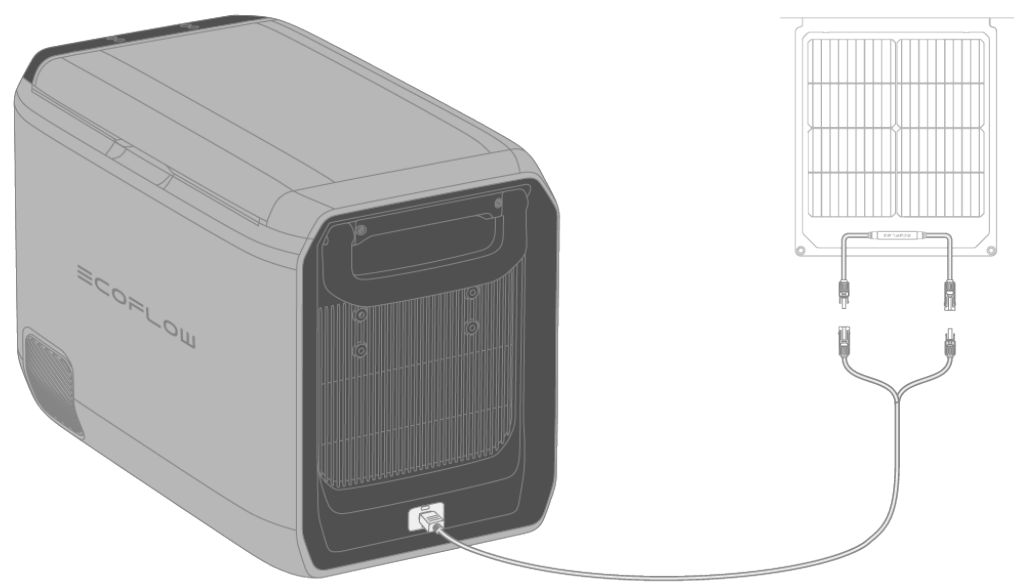

Notice

- The EcoFlow solar to XT60i charging cable and the solar panel are not included in the package.
- When using solar power, the plug-in battery must remain connected; otherwise, the refrigerator will not function properly.
- Before connecting the solar panel, please ensure its output voltage is within 30V to avoid damaging the refrigerator.

From a Cigarette Lighter Socket

Connection

Connect the refrigerator's input port to the vehicle's cigarette lighter using the included Car Charging Cable.

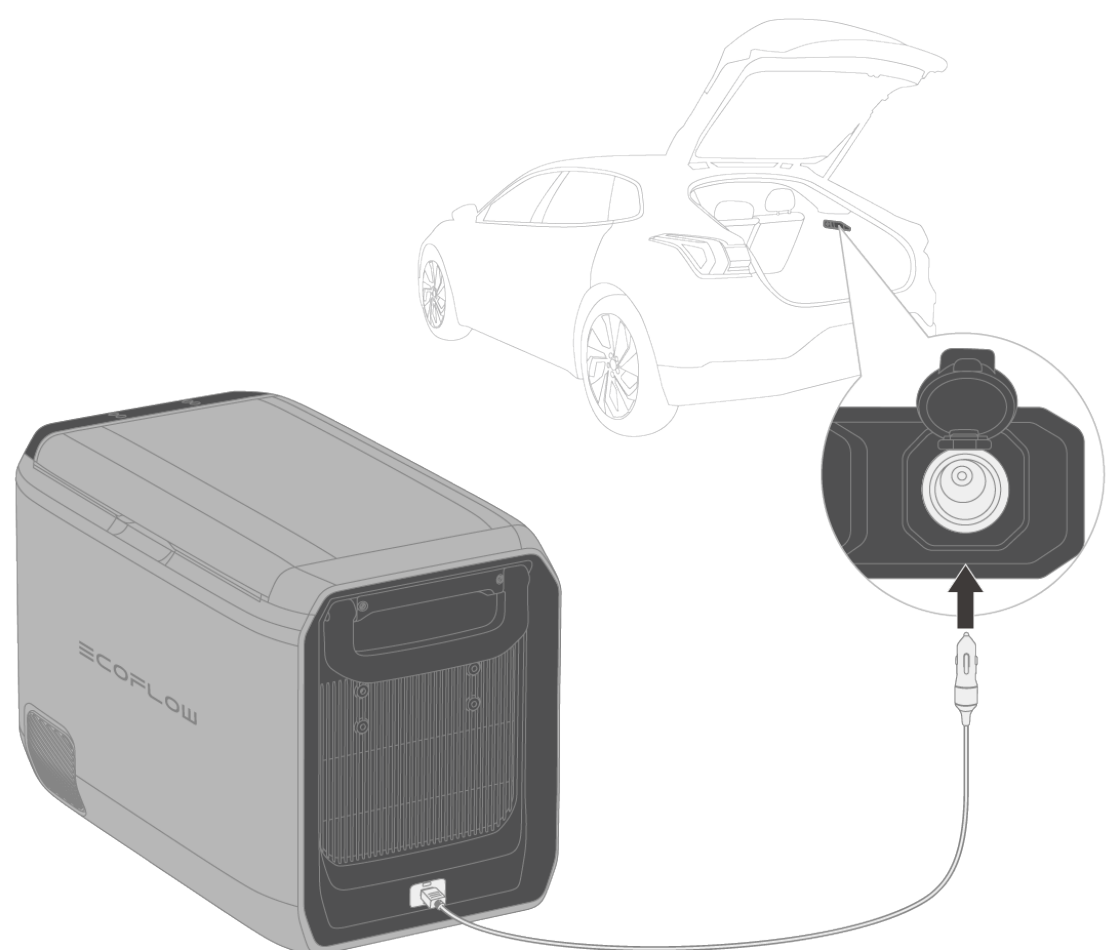

Car Battery Protection

The refrigerator features a car battery protection function to prevent the car battery from over-discharging.

This function has three levels: "Low," "Medium," and "High." At the "High" level, the protection is strongest, while at the "Low" level, the refrigerator

draws more power from the car battery.

You can enable or disable the vehicle battery protection function and adjust its level through the EcoFlow app.

 **Tip**

- The car battery protection function is set to "Medium" by default.
- To prevent ignition failure, it is recommended that the car battery protection be set to "Medium" or "High".

The three levels of the protection function correspond to different cut-off and operating voltages.

		Low	Medium	High
12V Car Battery	Cut-off voltage	10.1V	11.2V	11.8V
	Operating voltage	11.4V	12.2V	12.6V
24V Car Battery	Cut-off voltage	21.5V	24.1V	24.6V
	Operating voltage	23V	25.3V	26.2V

When the refrigerator is not connected to a plug-in battery, if the car battery voltage falls below the cut-off voltage, the refrigerator will automatically shut down. Once the car battery voltage rises back to the operating voltage level, the refrigerator will resume operation as it was before the protection was triggered.

When the refrigerator is connected to a plug-in battery, if the car battery voltage drops below the cut-off voltage, the refrigerator will switch to battery power and will not shut down automatically.

 **Tip**

When powering the refrigerator using a power station's cigarette lighter socket or a solar panel, if the power supply is not working properly, disable the car battery protection function via the EcoFlow app and try again.

Open the Lid



The refrigerator is equipped with two lid latches and supports double-side opening.

Press both lid latches simultaneously and lift the lid upward to remove it.



Tip

When repositioning the lid, ensure the correct orientation.

Power On/Off

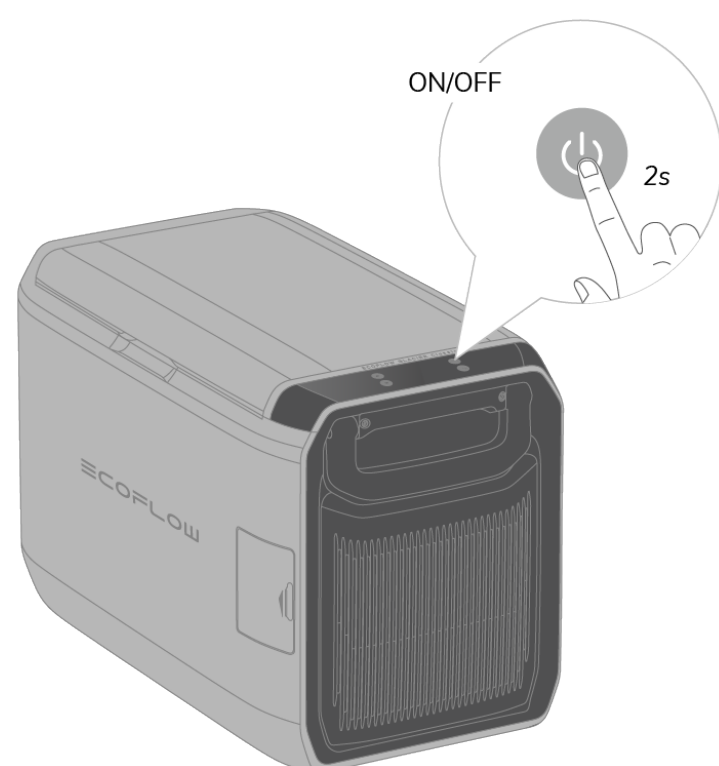

- **Power On/Off:** Press and hold the power button for about 2 seconds.
- **Turn Off the Display:** When the refrigerator is powered on, briefly press the power button to turn off the display.
- **Wake Up the Display:** Press any button to wake up the display with the refrigerator powered on.



Tip

- If no plug-in battery is connected, the refrigerator will automatically power on when connected to any power source.
- When a plug-in battery is connected, if the refrigerator is connected to any power source and the last shutdown was a manual shutdown, the refrigerator will not power on automatically. However, if the refrigerator was last shut down abnormally, the refrigerator will automatically power on.

Set Temperature

Single-Zone Setting

Temperature Adjustment

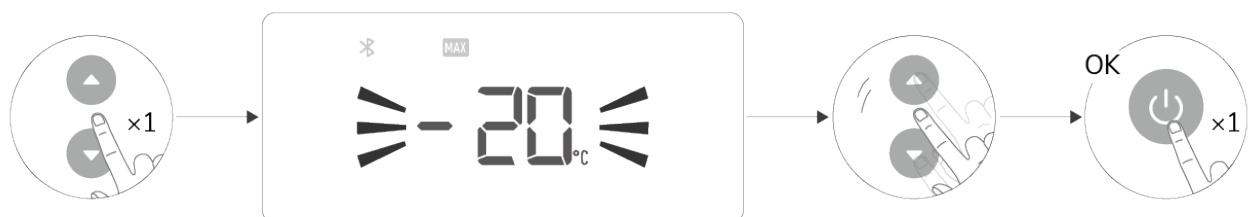

After the refrigerator is powered on, the display will show the real-time temperature of the temperature zone.

Press the adjustment button once to enter the temperature settings, and the temperature digits will begin flashing. Press the adjustment button again to **adjust the temperature**. Press and hold the adjustment button for fast adjustments.

If no action is taken within 3 seconds after adjusting, the settings will automatically be applied. Alternatively, you can press the power button once to **complete the settings** immediately without waiting.



Tip

The cooling capacity range is from -20°C to 20°C.

Temperature Unit Switch

The refrigerator supports both Celsius and Fahrenheit temperature units.

To switch between them, press and hold both the up and down adjustment buttons simultaneously for 2 seconds.

Dual-Zone Setting



Notice

Only 45L and 55L models support dual-zone settings.

Install the Temperature Zone Divider

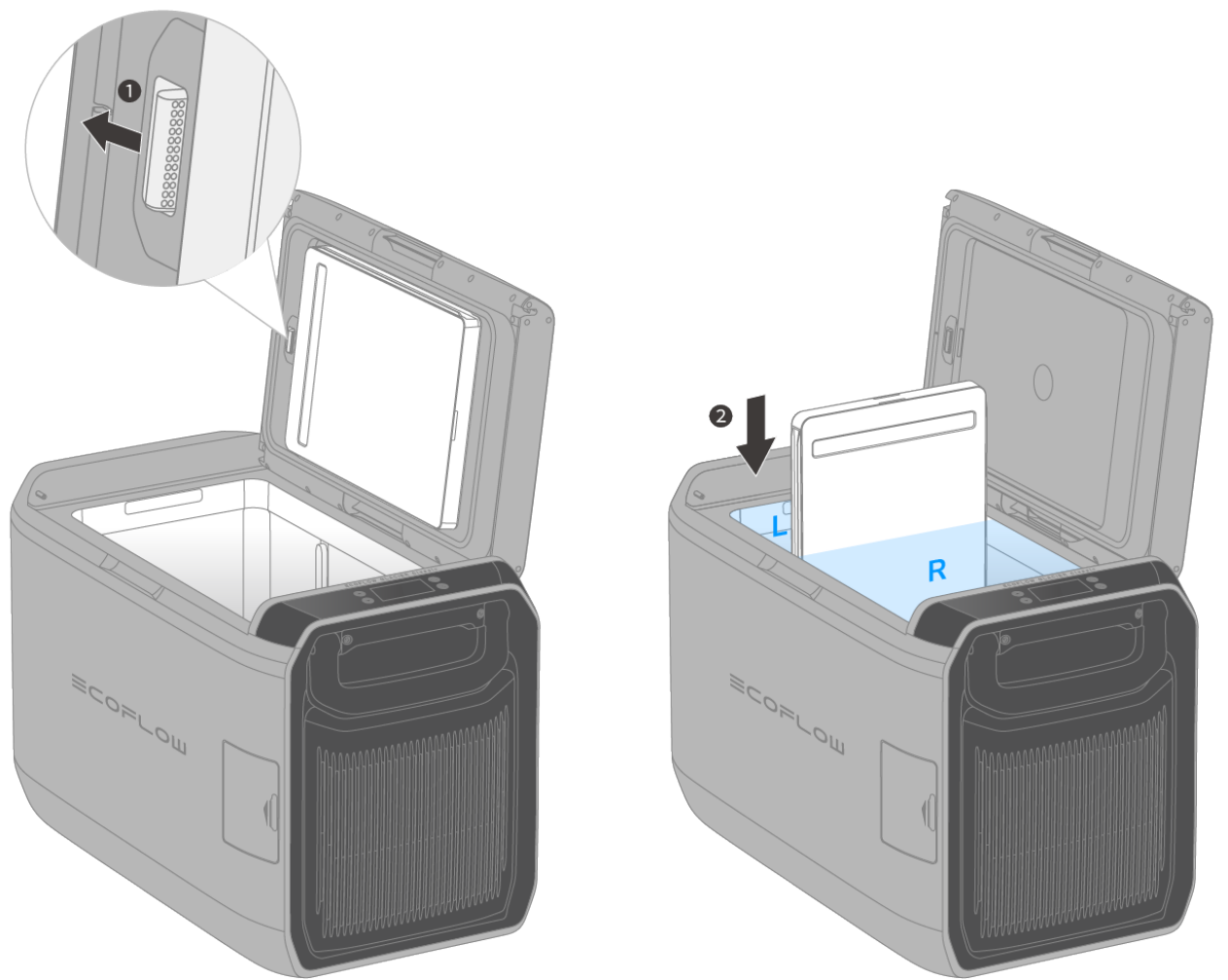

The 45L and 55L refrigerators come standard with a temperature zone divider.

When the divider is not installed, the refrigerator operates in single-zone status. After the divider is installed, the refrigerator switches to dual-zone status.

How to Install

1. Push the divider latch outward to remove the temperature zone divider from the bottom of the refrigerator lid.
2. Insert the divider along the divider location ribs and into the cabinet.
3. Once the divider is in place, the refrigerator will enter dual-zone status.

After installing the temperature zone divider, the smaller volume zone will be the left zone, and the larger volume zone, closer to the display, will be the right zone.



Tip

When not in use, the temperature zone divider can be stored on the bottom of the refrigerator lid.

Temperature Adjustment

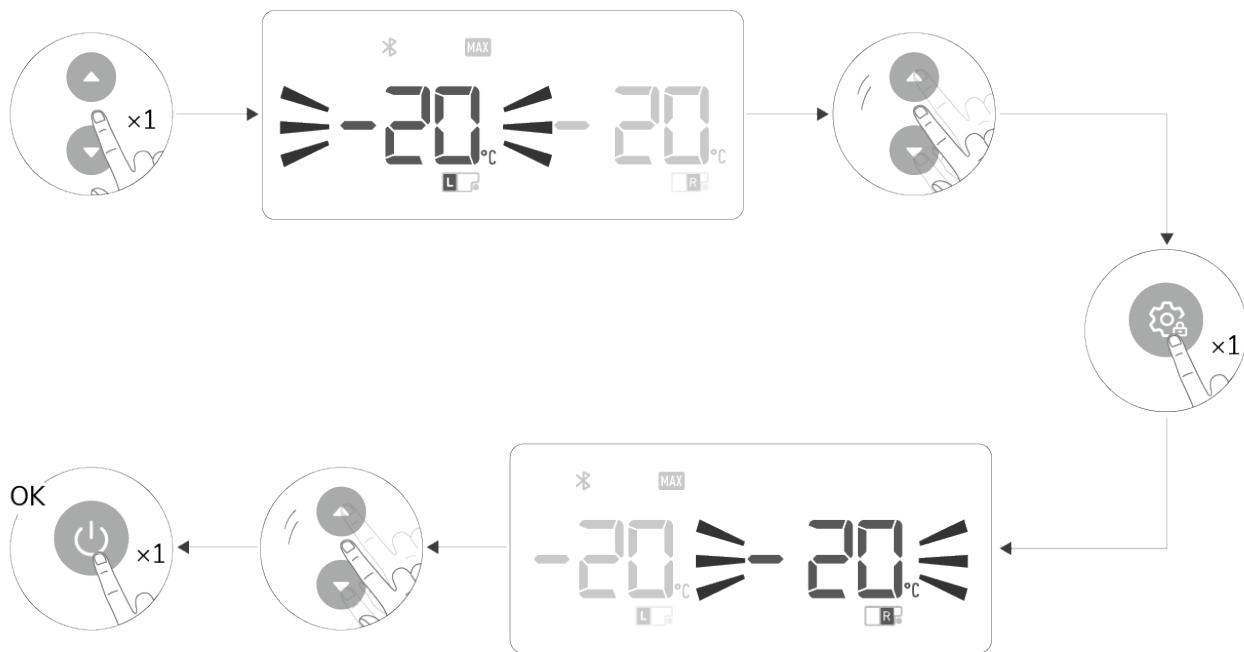

After the refrigerator is powered on, the display will show the real-time temperature of the temperature zones.

Press the adjustment button once to enter the temperature setting of the left zone, and the zone's temperature digits will begin flashing. Press the adjustment button again to **adjust the temperature**. Press and hold the adjustment button for fast adjustments.

When adjusting temperature, press the setting button once to **switch between zones**.

If no action is taken within 3 seconds after adjusting, the settings will automatically be applied. Alternatively, you can press the power button once to **complete the settings** immediately without waiting.

-  **Tips**
- The cooling capacity range is from -20°C to 20°C.
 - The temperature difference between the two zones can be up to 22°C.

Temperature Unit Switch

The refrigerator supports both Celsius and Fahrenheit temperature units.

To switch between them, press and hold both the up and down adjustment buttons simultaneously for 2 seconds.

Recommended Setting Temperature for Common Food



Notice

The recommended temperatures are for reference only.

Water	5°C
Fruit	5°C to 8°C
Juice	8°C to 10°C
Red wine	13°C
Drinks	5°C to 7°C

Vegetable	3°C to 10°C
Meat	−20°C to −18°C
Seafood	−3°C
Prepared food	4°C
Frozen food	−18°C

Switch Mode

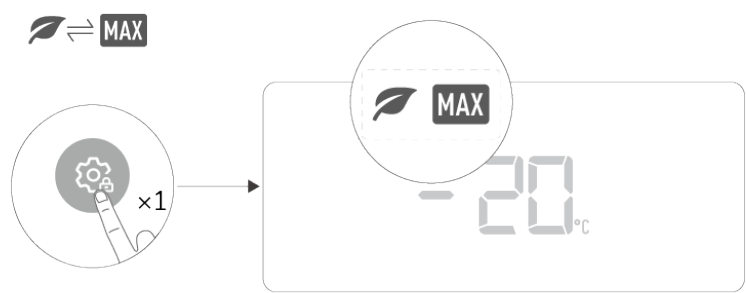

Press the setting button once to switch the refrigerator's operating mode.

The refrigerator offers two operating modes: Eco Mode and Max Mode.

Eco Mode: The refrigerator uses less power, extending running time.

Max Mode: The temperature control is quicker and more accurate, though power consumption is higher.

Child Lock

Enable/Disable Child Lock: Press and hold the setting button for 2 seconds.

The refrigerator features a child lock function. When enabled, all buttons on the control panel (including the power button) will be disabled to prevent accidental operation.

Management

Download EcoFlow App

EcoFlow offers a companion app for device management. With this mobile application, you can:

- Enjoy all-in-one control of your EcoFlow devices from anywhere.
- Monitor power consumption details seamlessly with real-time updates.
- Personalize your energy scheme with an array of customizable options.
- Promptly receive in-app troubleshooting and firmware updates.

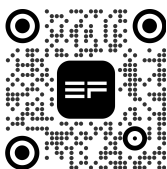

Scan the QR code or download it at:
<https://download.ecoflow.com/app>

Bind Device and Set Up Internet

After successfully registering an EcoFlow account, bind your EcoFlow devices to your account to ensure remote access to the device's settings.

To bind a new EcoFlow device:

1. Visit the EcoFlow app and log into your EcoFlow account.
2. Tap the Add Device button or **+** icon in the top right corner to search for new EcoFlow devices.
3. Select your EcoFlow device and follow the pop-up instructions to complete device binding and Wi-Fi setup.



Tip:

Unable to discover this power station via Bluetooth? Try the following:

- a. Power-off: Press and hold the power button for 2 seconds to turn off the refrigerator.
- b. Reset Bluetooth: While the refrigerator is turned off, press and hold the power button for about 5 seconds to reset all Bluetooth and Wi-Fi connections.
- c. Power on & Retry: Press the power button for 2 seconds to turn on the refrigerator and start searching again.

Control via Phone

With the EcoFlow app, you can manage all your EcoFlow binding devices on your phone.

The EcoFlow device supports Wi-Fi and Bluetooth connections, adapting to varying network conditions to ensure convenient access to device settings.

With Internet

When Wi-Fi is stable, you can access the device settings via the internet. This method is always recommended to ensure your EcoFlow device can receive timely firmware updates and pushes.



Without Internet

If the Wi-Fi connection is limited, you can manage the EcoFlow device locally via Bluetooth.



Food Storage Precautions

- Hot food should be cooled before putting it into the refrigerator. Otherwise, the temperature in the refrigerator will rise, affecting the freshness of other food and increasing the refrigerator's power consumption.
- Do not open the refrigerator lid frequently. Otherwise, the temperature inside the refrigerator will rise. Do not store too much food in the refrigerator. Otherwise, the refrigerator lid cannot close.
- Use plastic wrap or plastic bag to seal the container or use a covered container to store food, which can avoid the evaporation of food moisture, preserve the flavor and nutrition of food, and reduce the odor inside the refrigerator.
- When the set temperature is below 0°C, do not place glass bottles in the refrigerator to prevent the contents from freezing, which could cause the bottles to rupture and lead to injury.
- When the set temperature is below 0°C, do not touch the interior of the refrigerator or metal containers with wet hands, as this may cause frostbite.
- In the event of an unexpected power outage, avoid opening the refrigerator lid to preserve its cooling performance. Once the power is restored, check the contents of the refrigerator to ensure the food has not spoiled.

Maintenance and Care

Cleaning

1. Before cleaning, switch the refrigerator off and disconnect it from all sources of power to ensure safety.
2. Only use a soft cloth dampened with water or a mild, non-abrasive cleaner to clean the interior and exterior of the refrigerator. Before cleaning, ensure the cloth is not dripping wet.
3. Do not rinse the refrigerator with running water or submerge it in water.
4. Ensure that the air inlet and outlet on the refrigerator are free of dust and dirt to maintain proper ventilation.
5. After cleaning, ensure the refrigerator is completely dry, and that all ports and cables are free of any liquid before connecting to a power source.



Tip

When the ambient humidity is high, condensation may form on the refrigerator's surface after it has been running for a while. Simply wipe it dry with a soft cloth.

Drainage



If there is water accumulated inside the refrigerator, remove the drain plug at the bottom of the cabinet to drain it.

Defrosting

Humidity can form frost in the interior of the refrigerator. This reduces the cooling capacity. Follow the steps below for regular defrosting:

1. Remove all items from the refrigerator. If necessary, store them in another refrigerator to keep them cool.
2. Turn off the refrigerator’s power.
3. Open the refrigerator lid and allow the frost to thaw naturally.
4. Remove the drain plug to drain the water, then use a soft cloth to remove any remaining water.



Notice

Do not use mechanical devices or other methods not recommended by the manufacturer to speed up the defrosting process.

Storage

If the refrigerator is left unused for an extended period, follow these steps:

1. Switch the refrigerator off and disconnect it from all sources of power.
2. Defrost the refrigerator.
3. Clean and dry the refrigerator.
4. After the interior and the exterior are completely dry, close the refrigerator lid.

Safety Instructions and Regulatory Compliance

Disclaimer

Please read the product documentation thoroughly and ensure you understand

it before using the product. Improper use may cause serious injury, product damage, or property loss. Always refer to the most up-to-date documentation available at <https://www.ecoflow.com/support/download>. This documentation takes precedence over all other versions.

By using this product, you acknowledge and agree to all terms and conditions stated in the documentation. EcoFlow is not liable for losses caused by improper use or failure to adhere to the provided instructions. Subject to applicable laws and regulations, EcoFlow reserves the right to the final interpretation of this document and all documents related to the product.

Safety Instructions

Environment

1. Store the product in a tidy, dry, and well-ventilated place.
2. Do not expose the product to rain.
3. Do not use the product near a heat source, such as a fire source or a heating furnace.

Operation

1. WARNING: Keep ventilation openings, in the appliance enclosure or in the built-in structure, clear of obstruction.
2. Place the product on a stable and flat surface. Avoid damage to the device or personal injury due to the product falling or tipping over.
3. When transporting the product, carry it horizontally and avoid tilting.
4. To prevent damage, do not allow water to enter the product's internal components, such as ports and air vents.
5. Do not subject this product to severe impacts, vibrations, or drops. In case of a severe impact, stop using this product immediately and turn off the power.
6. Do not disassemble, repair, or modify this product by yourself. For any repair service, please contact EcoFlow Customer Service.
7. Always disconnect the product from all external power sources before attempting any service or maintenance.
8. Do not use any unofficial or unrecommended components or accessories. For any replacements, please contact EcoFlow for further assistance.
9. Do not operate this product with a damaged cord or plug.
10. Before starting the product, ensure that the power cord and the plug are dry and securely connected.
11. Please wait for more than 10 seconds when unplugging and reconnecting the power plug. Otherwise, the product may malfunction.
12. To reduce risk of damage to the electric plug and cord, pull the plug rather than the cord when disconnecting the product.
13. Do not touch exposed cables with your bare hands. This applies especially when operating the product from the AC mains.
14. Disconnect the product from all external power sources after use or before cleaning.
15. When positioning the product, ensure the supply cord is not trapped or damaged.
16. Do not place multiple portable socket outlets or portable power supplies at the rear of the product.
17. Do not obstruct the air inlet or air outlet during operation.
18. Do not insert wires or other metal objects into the product's air inlet, air

- outlet or port to prevent short circuits.
19. Do not damage the refrigerant circuit.
 20. WARNING: Do not use mechanical devices or other means to accelerate the defrosting process, other than those recommended by the manufacturer.
 21. WARNING: Do not use electrical appliances inside the food storage compartments of the appliance, unless they are of the type recommended by the manufacturer.
 22. WARNING: Do not store explosive substances such as aerosol cans with a flammable propellant in this appliance.
 23. The product is not suitable for transporting caustic materials or materials containing solvents.
 24. Do not fill the inner container with liquid.
 25. To avoid contamination of food, please follow the instructions below:
 - Please check if the cooling capacity of the device is suitable for storing the food or medicine you wish to cool.
 - Store food in its original packaging or in suitable containers.
 - Avoid opening the cooling device for extended periods, as this can significantly increase the temperature inside the compartments.
 - Regularly clean the surfaces and drainage outlets that may come in contact with food.
 26. Do not stack any heavy objects on the product.
 27. Before opening the refrigerator door, ensure that no items are placed on top of the refrigerator to prevent them from falling.
 28. Keep the product out of reach of children and pets. If the product is to be used near children, they should be closely supervised.
 29. If the product is left empty for extended periods:
 - Switch off the product and disconnect it from all sources of power.
 - Defrost the product.
 - Clean and dry the product.
 - After the interior and exterior of the refrigerator are completely dry, close the lid.
 30. This appliance is intended to be used in household and similar applications such as:
 - staff kitchen areas in shops, offices and other working environments;
 - farm houses and by clients in hotels, motels and other residential type environments;
 - bed and breakfast type environments;
 - catering and similar non-retail applications;
 - camping use:
 - suitable for camping use;
 - the appliance shall not be exposed to rain.

In Case of Emergency

1. Do not operate the product if it is visibly damaged. Immediately stop the product and switch off all power supplies.
2. In case of emergency, take precautions against electric shock before touching the product, such as wearing insulating gloves.
3. If you notice a strong odor, ventilate the area immediately, turn off the product, avoid using electrical appliances or open flames nearby, and contact EcoFlow customer support for assistance.
4. If the product or cables start to smoke or catch fire, cut off the power immediately and call the fire department. It is recommended to use a dry powder or carbon dioxide fire extinguisher to extinguish the fire.
5. In case of an unexpected power outage, try to avoid opening the

refrigerator lid to preserve its cooling performance.

Recycling and Disposal

1. Remove the doors before disposing of the product to prevent the risk of child entrapment.
2. The insulation of the product contains flammable cyclopentane and requires special disposal procedures. Deliver the product at the end of its life cycle to an appropriate recycling center.

Battery Use

1. This product is only compatible with the EcoFlow GLACIER Plug-in Battery (Model: EFBX100-EB).
2. Do not use non-rechargeable batteries.
3. WARNING: For the purposes of recharging the battery, only use the detachable supply unit provided with this appliance.
4. If the chemical substance inside the battery leaks accidentally, do not touch or inhale it. Once it accidentally contacts the skin or eyes, wash it with plenty of water, and take medical measures if necessary.
5. To dispose of the battery, follow the instructions below:
 - When conditions permit, be sure to completely discharge the battery before placing the battery in the designated battery recycling bin. Batteries are dangerous chemicals and should not be disposed of in ordinary trash bins. For details, follow the local battery recycling and disposal laws and regulations.
 - If the battery cannot be completely discharged due to battery failure, do not dispose of the battery directly in the battery recycling bin, and contact a professional battery recycling company for further processing.
 - If the battery cannot start after being discharged, dispose of it according to local laws and regulations on battery recycling and disposal.

Regulatory Compliance

FCC Compliance Statement

Any Changes or modifications not expressly approved by the party responsible for compliance could void the user's authority to operate the equipment.

This device complies with part 15 of the FCC Rules. Operation is subject to the following two conditions:

- (1) This device may not cause harmful interference, and
- (2) this device must accept any interference received, including interference that may cause undesired operation.

This equipment has been tested and found to comply with the limits for a Class B digital device, pursuant to Part 15 of the FCC Rules. These limits are designed to provide reasonable protection against harmful interference in a residential installation. This equipment generates uses and can radiate radio frequency energy and, if not installed and used in accordance with the instructions, may cause harmful interference to radio communications. However, there is no guarantee that interference will not occur in a particular installation. If this equipment does cause harmful interference to radio or television reception, which can be determined by turning the equipment off and on, the user is encouraged to try to correct the interference by one of the following measures:

- Reorient or relocate the receiving antenna.

- Increase the separation between the equipment and receiver.
- Connect the equipment into an outlet on a circuit different from that to which the receiver is connected.
- Consult the dealer or an experienced radio/TV technician for help.

RF Exposure Statement

This equipment complies with the FCC radiation exposure limits set forth for an uncontrolled environment. This transmitter must not be co-located or operating in conjunction with any other antenna or transmitter.

IC Compliance Statement

This device complies with Industry Canada licence-exempt RSS standard(s) Operation is subject to the following two conditions:

- (1) this device may not cause interference, and
- (2) this device must accept any interference, including interference that may cause undesired operation of the device.

Le présent appareil est conforme aux CNR d'Industrie Canada applicables aux appareils radio exempts de licence. L'exploitation est autorisée aux deux conditions suivantes:

- (1) l'appareil ne doit pas produire de brouillage, et
- (2) l'utilisateur de l'appareil doit accepter tout brouillage radioélectrique subi, même si le brouillage est susceptible d'en compromettre le fonctionnement.

This Class B digital apparatus complies with Canadian ICES-003.

Cet appareil numérique de la classe B est conforme à la norme NMB-003 du Canada.

CAN ICES(B) / NMB(B)

RF Exposure Statement

This equipment complies with the ISED radiation exposure limits set forth for an uncontrolled environment. This transmitter must not be co-located or operating in conjunction with any other antenna or transmitter.

Cet équipement est conforme aux limites d'exposition aux rayonnements de l'ISED établies pour un environnement non contrôlé. Cet émetteur ne doit pas être co-localisé ou fonctionner en conjonction avec une autre antenne ou un autre émetteur.



The Bluetooth® word mark and logos are registered trademarks owned by Bluetooth SIG, Inc. and any use of such marks by EcoFlow Inc. is under license. Other trademarks and trade names are those of their respective owners.



WEEE

This marking indicates that this product should not be disposed of with other household waste within the EU. Recycle this product properly to prevent possible damage to the environment or a risk to human health via uncontrolled waste disposal and in order to promote the sustainable reuse of material resources. Please return your used product to an appropriate collection point or contact the retailer where you purchased this product. Your retailer will accept used products and return them to an environmentally-sound recycling facility.

For information on the disposal of electrical and electronic equipment, please visit the following website:

<https://eu.ecoflow.com/pages/electronic-devices-disposal>

CE

Hereby, EcoFlow Inc. declares that the product is in compliance with Directives 2014/53/EU, 2011/65/EU+(EU) 2015/863, (EU) 2019/2019, (EU) 2019/2016. The full text of the EU Declaration of Conformity is available at the following Internet addresses:
<http://www.ecoflow.com/eu/eu-compliance>

Radio Frequency (RF) Specifications for EU

Bluetooth

Frequency: 2402 MHz - 2480 MHz

Maximum Output Power: 8.59 dBm

WLAN

Frequency: 2412 MHz - 2472 MHz

Maximum Output Power: 18.13 dBm

Detachable Supply Unit

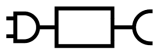

产品中有害物质的名称及含量

部件名称	有害物质					
	铅(Pb)	汞(Hg)	镉(Cd)	六价铬(Cr(VI))	多溴联苯(PBB)	多溴二苯醚(PBDE)
塑料结构件	○	○	○	○	○	○
金属结构件	○	○	○	○	○	○
电路板组件	×	○	○	○	○	○
电源线/连接线	×	○	○	○	○	○
<div>本表格依据 SJ/T11364 的规定编制。 ○：表示该有害物质在该部件所有均质材料中的含量均在 GB/T226572 规定的限量要求以下。 ×：表示该有害物质至少在该部件的某一均质材料中的含量超出 GB/T26572 规定的限量要求。 备注: 以上标注“×”的部件是由于目前行业水平所限, 暂时无法实现替代或减量, 且完全符合欧盟 RoHS 指令要求 (属于豁免的部分)。</div>						

Compliance Warning



Warning; Risk of fire/flammable materials

1.

WARNING: System contains refrigerant under high pressure. Do not tamper with the system. It must be serviced by qualified persons only.
2.

DANGER – Risk of fire or explosion. Flammable refrigerant used. Do not use mechanical devices to defrost refrigerator. Do not puncture refrigerant tubing.

3. DANGER – Risk of fire or explosion. Flammable refrigerant used. To be repaired only by trained service personnel. Use only manufacturer-authorized service parts. Any repair equipment used must be designed for flammable refrigerants. Follow all manufacturer repair instructions. Do not puncture refrigerant tubing.
4. CAUTION – Risk of fire or explosion. Dispose of refrigerator properly in accordance with the applicable federal or local regulations. Flammable refrigerant used.
5. CAUTION – Risk of fire or explosion due to puncture of refrigerant tubing; Follow handling instructions carefully. Flammable refrigerant used.
6. Suitable for Outdoor Use
7. WARNING Fill With Potable Water Only.
8. WARNING Keep Ventilation Openings, In The Appliance Enclosure Or In The Built-In Structure, Clear Of Obstruction.
9. WARNING Do Not Use Mechanical Devices Or Other Means To Accelerate The Defrosting Process, Other Than Those Recommended By The Manufacturer.
10. WARNING Do Not Damage The Refrigerant Circuit.
11. WARNING Do Not Use Electrical Appliances Inside The Food Storage Compartments Of The Appliance, Unless They Are Of The Type Recommended By The Manufacturer.
12. WARNING: When positioning the appliance, ensure the supply cord is not trapped or damaged.
13. WARNING: Do not locate multiple portable socket-outlets or portable power supplies at the rear of the appliance.
14. WARNING: Connect to potable water supply only.
15. WARNING: To avoid a hazard due to instability of the appliance, it must be fixed in accordance with the instructions.
16. WARNING: The refrigeration system is under high pressure. Do not tamper with it. Contact qualified service personal before disposal.
17. CAUTION To Prevent A Child From Being Entrapped, Keep Out Of Reach Of Children And Not In The Vicinity Of Freezer (Or Refrigerator).
18. WARNING: Risk of child entrapment. Before you throw away your old refrigerator or freezer:
 - *Take off the doors.
 - *Leave the shelves in place so that children may not easily climb inside.

Appendix

What's in the Box

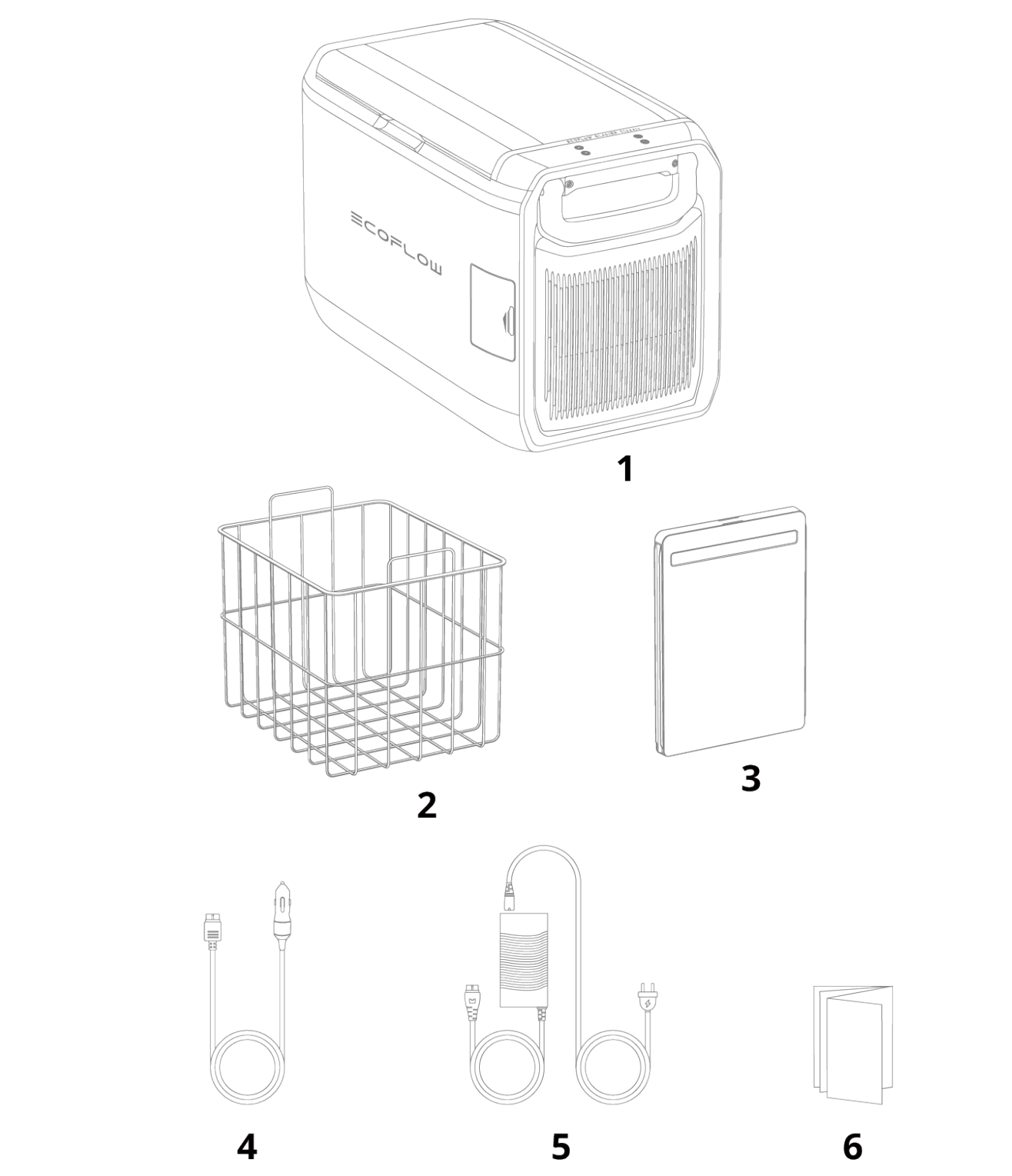

- 1. GLACIER Classic
- 2. Basket
- 3. Temperature Zone Divider (45L/55L Only)
- 4. Car Charging Cable
- 5. AC Power Adapter
- 6. Product Documents

 If any item is damaged or missing, contact EcoFlow Customer Service for assistance.

Specificalitons

Model	35L: EF-GC-H-35
	45L: EF-GC-H-45
	55L: EF-GC-H-55
Dimensions	35L: 706×400×405 mm (27.8×15.7×15.9 inch)
	45L: 706×400×480 mm (27.8×15.7×18.9 inch)
	55L: 706×466×480 mm (27.8×18.3×18.9 inch)
	35L: Approx. 20.5 kg (45.2 lbs)

Net Weight	45L: Approx. 23.2 kg (51.2 lbs) 55L: Approx. 25.2 kg (55.6 lbs)
Climate Class	SN/N/ST/T
Operational Volume (Single Zone)	35L: 35L 45L: 45L 55L: 55L
Operational Volume (Dual Zone)	45L: 42 L 55L: 52 L
IP Rating	IPX4
Cooling Capacity	−20°C to 20°C (−4°F to 68°F)
Working Mode	Max mode and Eco mode
Compressor Power Rating	55W
Refrigerant Type and Amount	35L: R600a, 22 g 45L: R600a, 23 g 55L: R600a, 25 g
Foaming Agent	Cyclopentane
Average Noise (Sound Pressure Level)	< 38.5 dB
Wi-Fi	2.4G Wi-Fi supported only
Bluetooth	Supported
AC Input	100-240V~50/60Hz, 95W Max
Battery Input	21.6V==
Solar Input	11-30V==8A Max, 110W Max
Car Input	12/24V==8A Max, 100W Max
Operating Temperature	−10°C to 50°C (14°F to 122°F)
Storage Temperature	−20°C to 60°C (−4°F to 140°F)